

Baxter Road

16-22

24-30

32-38

2-8

# SITE 5

Kingsley Road

6no 1b/2p

HT-1B

Gardens to flats on Baxter Road

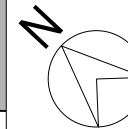

1:200

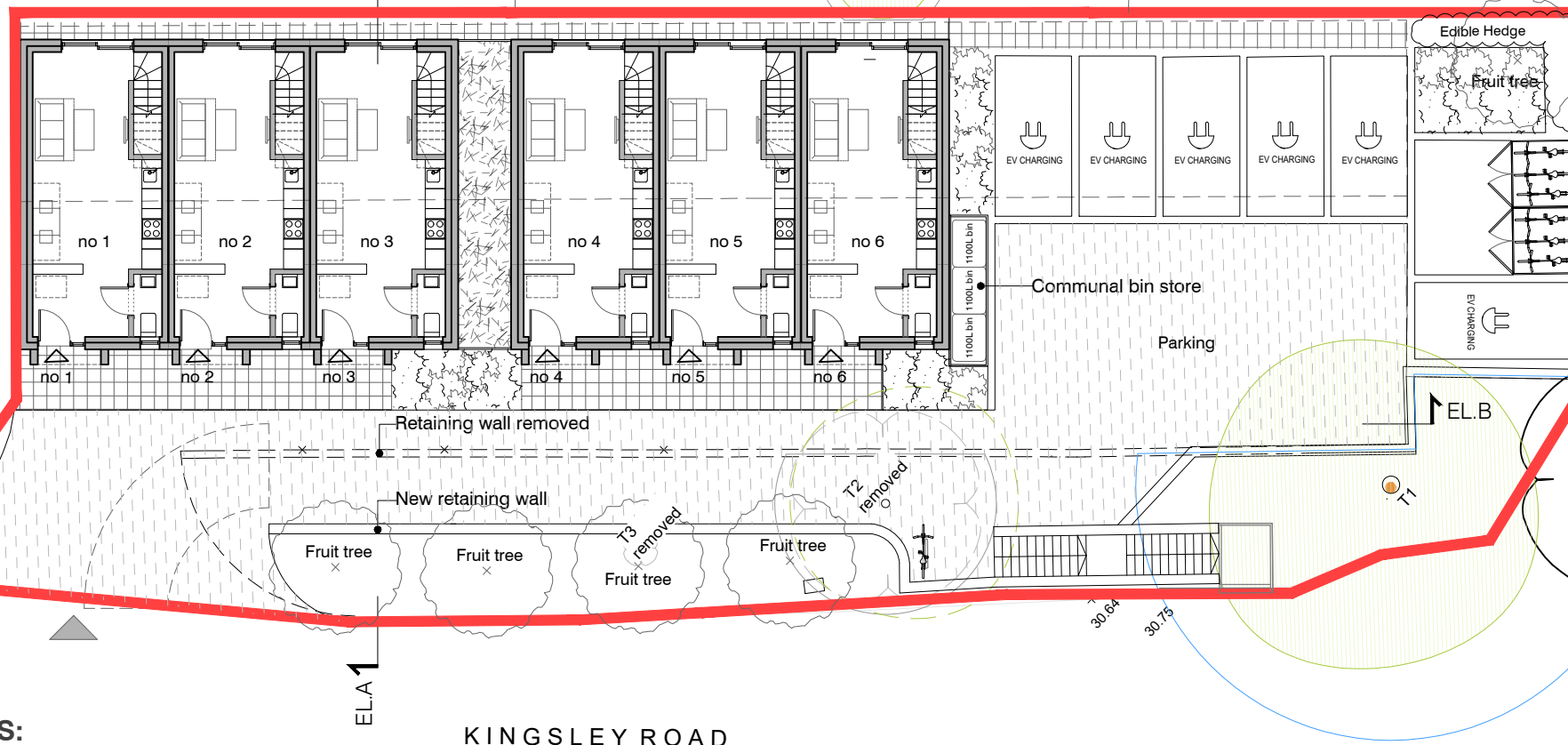
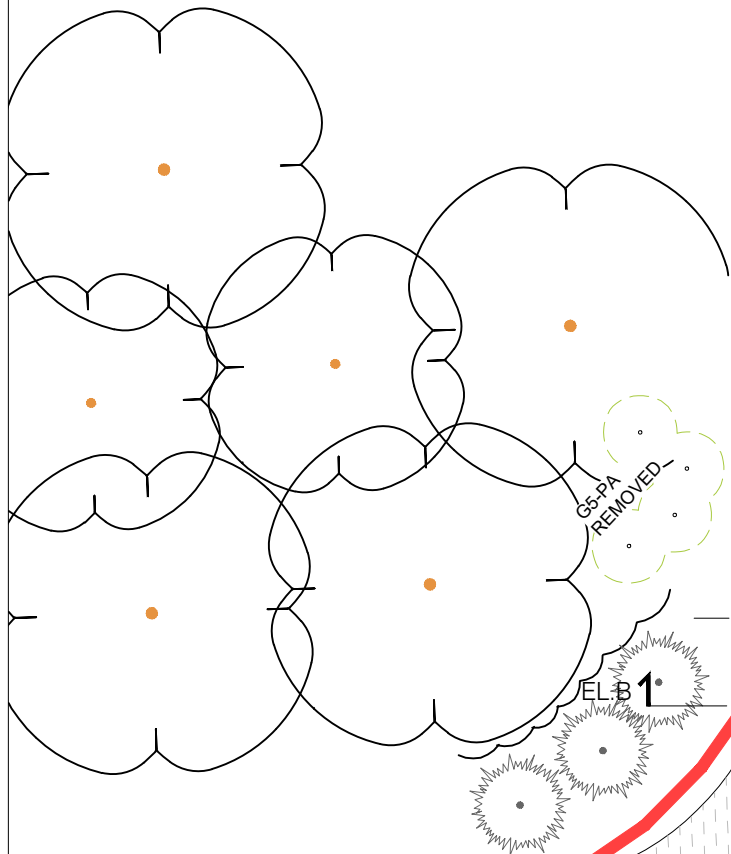

01 PROPOSED SITE PLAN  
1:200

### PLANNING NOTES:

**Fire:** Access to site is wide enough for Fire Tender access from highway.

**Waste:** Residents deposit waste in communal bin store located centrally on site. Waste vehicle stops on highway on collection day.

**RPA / Arboricultural:** With the exception of T2 and G5-PA, encroachment within RPAS is avoided with the layout shown.

THE CONTRACTOR MUST VERIFY ALL DIMENSIONS ON SITE BEFORE MAKING SHOP DRAWINGS OR COMMENCING WORK OF ANY KIND. NO DIMENSIONS TO BE SCALED FROM THIS DRAWING

1. THE BOUNDARIES SHOWN ARE BASED ON INFORMATION BY OTHERS. ALL BOUNDARIES TO BE VERIFIED ON SITE PRIOR TO COMMENCING CONSTRUCTION.
2. TOPOGRAPHICAL LEVELS TO BE CONFIRMED.
3. DESIGN & QUOTED AREAS ARE SUBJECT TO DESIGN DEVELOPMENT & STATUTORY CONSENTS.
4. ALL SURVEY INFORMATION SHOWN IS SUBJECT TO FURTHER SITE INVESTIGATION DURING DEMOLITION.

REV	DATE	REVISIONS	CHK

**mohsin cooper**  
ARCHITECTS

MOHSIN COOPER LIMITED, 7 HOVE MANOR PARADE,  
HOVE STREET, HOVE, EAST SUSSEX, BN3 2DF  
www.mohsincooper.com  
© COPYRIGHT EXISTS ON THE DESIGN  
AND INFORMATION SHOWN ON THIS DRAWING

**PROJECT :**  
Garages to Kingsley Road, Lewes, BN7 2TT

**CLIENT :**  
Lewes District Council

**DRAWING TITLE :**  
PROPOSED SITE PLAN

<b>SCALE :</b> 1:200 @ A3	<b>DRAWN :</b> MC	<b>DATE :</b> APR 24
	<b>CHECKED :</b> MC	<b>DATE :</b> APR 24

<b>NUMBER:</b> 0495 - KG - 001	<b>REVISION:</b> -
-----------------------------------	-----------------------

<b>STATUS:</b> S2	<b>PLANNING APPLICATION</b>
----------------------	-----------------------------